



CAST IRON GLOBE TYPE SILENT CHECK VALVE

Model 1422



PRESSURE RATING:

PN 16

PRODUCT ORIGIN:

China

MATERIALS:

Body
Cast Iron

Trim
Stainless Steel 316

COATING:

Fusion bonded epoxy coated internally and externally in red, blue or black

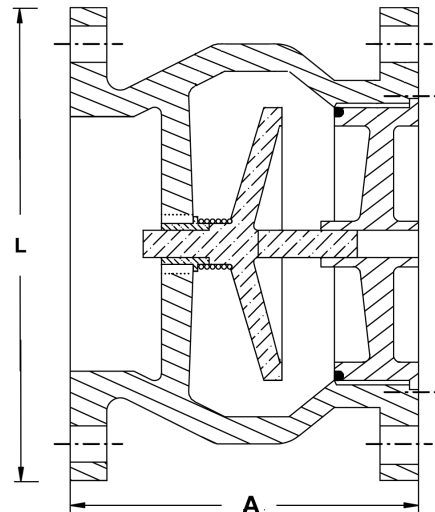

DIMENSIONS:

DN	50	65	80	100	150	200	250	300
L	165	185	200	220	285	340	405	460
A	142	147	165	194	252	320	398	374

* All dimensions in mm.